

ZWMD008008

齿轮箱规格 Gearbox Specifications

外径	Outer diameter	8mm	轴承	Bearing	含油轴承 Porous bearing
材质	Material	五金 Metal	轴向窜动	Axial endplay	≤0.3mm
旋转方向	Direction of rotation	cw & ccw	输出轴径向负载	Radial loading on output shaft	≤2N
齿轮箱回程差	Gear backlash	≤3°	工作温度	Operating temperature range	-20 ~ +85°C

齿轮级数 Gearbox Stages

	1	2	3	4
减速比	4 / 5	13 / 19 / 28	47 / 69 / 102 / 152	168 / 249 / 369 / 546 / 809
最大容许扭力 (gf.cm)	250	400	600	750
瞬间容许力矩 (gf.cm)	500	800	1200	1500
齿轮箱效率 (%)	85	73	62	55
长度 (mm)	11.6	14.3	17	19.7

技术插图 | Technical Drawing

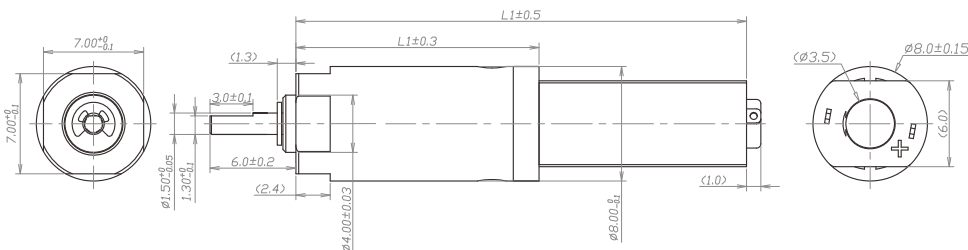

马达规格参数 Motor Specifications

马达(可选择) Motor type (optional)	直流有刷电机、步进电机 Brushed DC motor, Stepper motor	输入速度 Input speed	≤3000rpm
电压(可选择) Voltage (optional)	3-12V	电流 Current	150mA max

型号 Model	Rated Speed 额定转速	Max Speed 最高转速	Max Rated Torque 额定容许力矩	Max Instant Torque 瞬间容许力矩	Reduction Ratio 减速比	Gearbox Length 减速箱长 L1	Overall Length 总长 L
	rpm	rpm	gf.cm	gf.cm		mm	mm
ZWMD008008-4	3361	4630	250	500	3.6	11.6	26.1
ZWMD008008-5	2269	3125	250	500	5.3		
ZWMD008008-13	934	1228	400	800	13.0	14.3	28.8
ZWMD008008-19	630	829	400	800	19.2		
ZWMD008008-28	425	559	400	800	28.4		
ZWMD008008-47	259	335	600	1200	46.7	17.0	31.5
ZWMD008008-69	175	226	600	1200	69.1		
ZWMD008008-102	118	153	600	1200	102.4		
ZWMD008008-152	80	103	600	1200	151.7		
ZWMD008008-168	72	91	750	1500	168.0	19.7	34.2
ZWMD008008-249	49	62	750	1500	248.8		
ZWMD008008-369	33	42	750	1500	368.6		
ZWMD008008-546	22	28	750	1500	546.1		
ZWMD008008-809	15	19	750	1500	809.1		

注：可根据客户要求定制 Please contact us for customized products