

ZWBMD006006

齿轮箱规格 Gearbox Specifications

外径	Outer diameter	6mm	轴承	Bearing	含油轴承 Porous bearing	滚动轴承 Rolling bearing
材质	Material	五金 Metal	轴向窜动	Axial endplay	≤0.3mm	≤0.3mm
旋转方向	Direction of rotation	cw & ccw	输出轴径向负载	Radial loading on output shaft	≤0.5N	≤5N
齿轮箱回程差	Gear backlash	≤3°	工作温度	Operating temperature range	-20 ~ +85°C	

齿轮级数 Gearbox Stages

		1	2	3	4
减速比	Reduction ratio	5 / 6	23 / 31 / 41	110 / 148 / 198 / 266	531 / 711 / 952 / 1275 / 1708
最大容许扭力 (gf.cm)	Max rated torque of gearbox (gf.cm)	330	330	330	600
瞬间容许力矩 (gf.cm)	Instant torque of gearbox (gf.cm)	800	800	800	1500
齿轮箱效率 (%)	Gearbox efficiency (%)	87	74	63	56
长度 (mm)	Gearbox length L1 (mm)	9.7	12.1	14.5	16.9

技术插图 | Technical Drawing

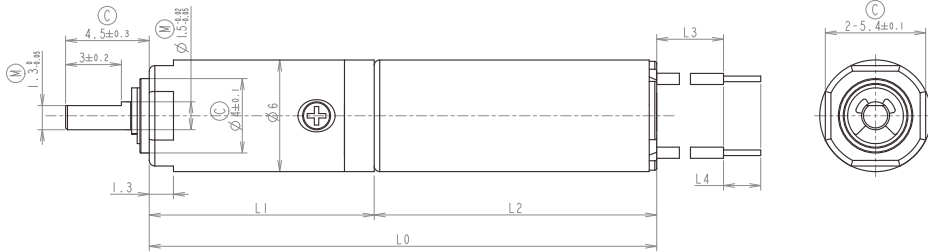

马达规格参数 Motor Specifications

马达(可选择) Motor type (optional)	空心杯电机、步进电机 Coreless motor, Stepper motor	输入速度 Input speed	≤3000rpm
电压(可选择) Voltage (optional)	3-12V	电流 Current	100mA max

型号 Model	Rated Speed 额定转速	Max Speed 最高转速	Max Rated Torque 额定容许力矩	Max Instant Torque 瞬间容许力矩	Reduction Ratio 减速比	Gearbox Length 减速箱长 L1	Overall Length 总长 L
	rpm	rpm	gf.cm	gf.cm		mm	mm
ZWBMD006006-5	1563	6250	330	800	4.8	9.7	23.7
ZWBMD006006-6	1166	4666	330	800	6.43		
ZWBMD006006-23	326	1302	330	800	23.04	12.1	26.1
ZWBMD006006-31	243	972	330	800	30.86		
ZWBMD006006-41	181	726	330	800	41.33		
ZWBMD006006-110	68	271	330	800	110.6	14.5	28.5
ZWBMD006006-148	51	203	330	800	148.1		
ZWBMD006006-198	38	151	330	800	198.4		
ZWBMD006006-266	28	113	330	800	265.7		
ZWBMD006006-531	14	57	600	1500	530.8	16.9	30.9
ZWBMD006006-711	11	42	600	1500	711.0		
ZWBMD006006-952	8	32	600	1500	952.2		
ZWBMD006006-1275	6	24	600	1500	1275.2		
ZWBMD006006-1708	4	18	600	1500	1707.9		

注：可根据客户要求定制 Please contact us for customized products